

6.



ERŐMŰ-TŐ PART

AMÉN UTCA

melyre ha szék

melyre ha szék

7 d

7.

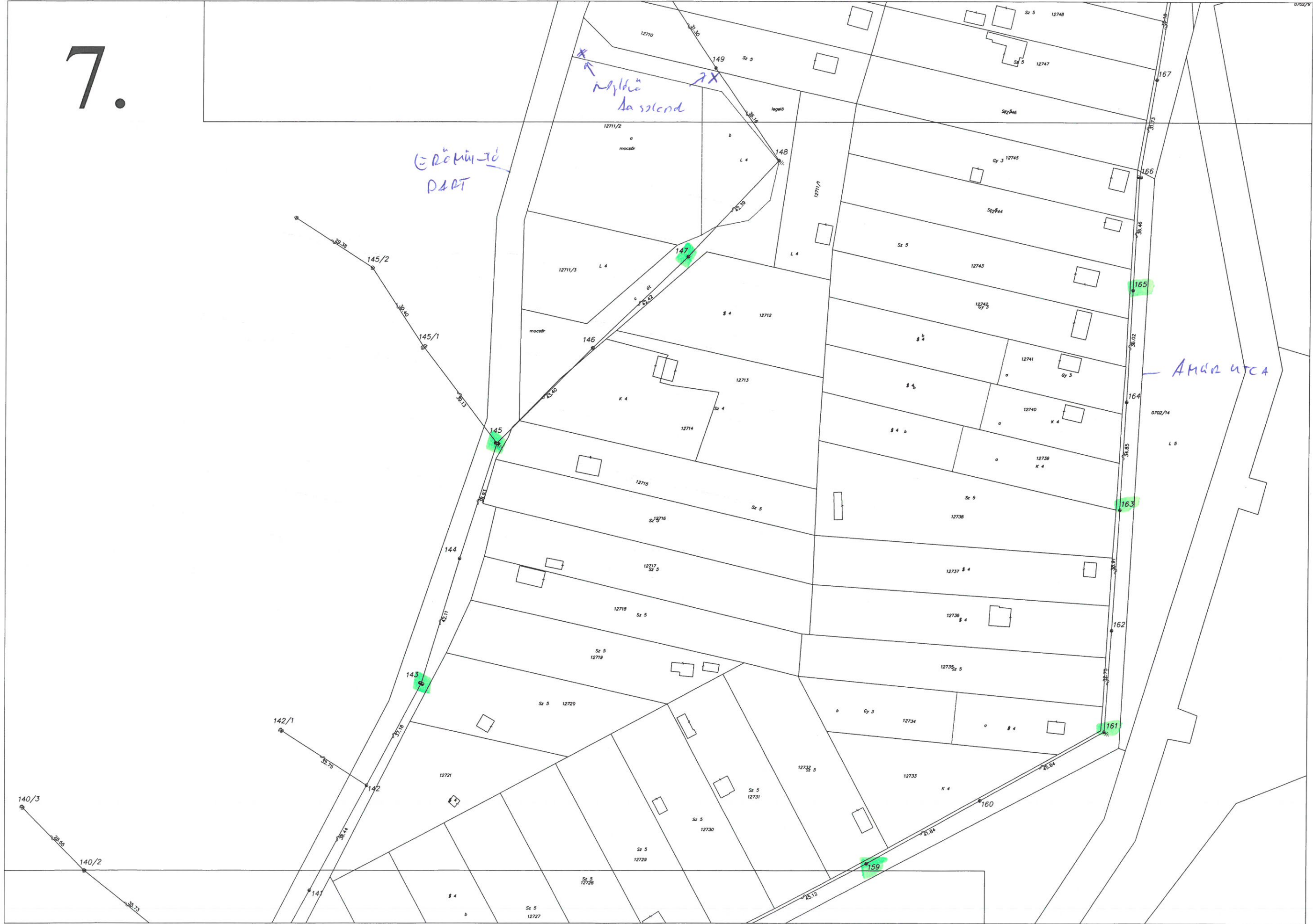

8.

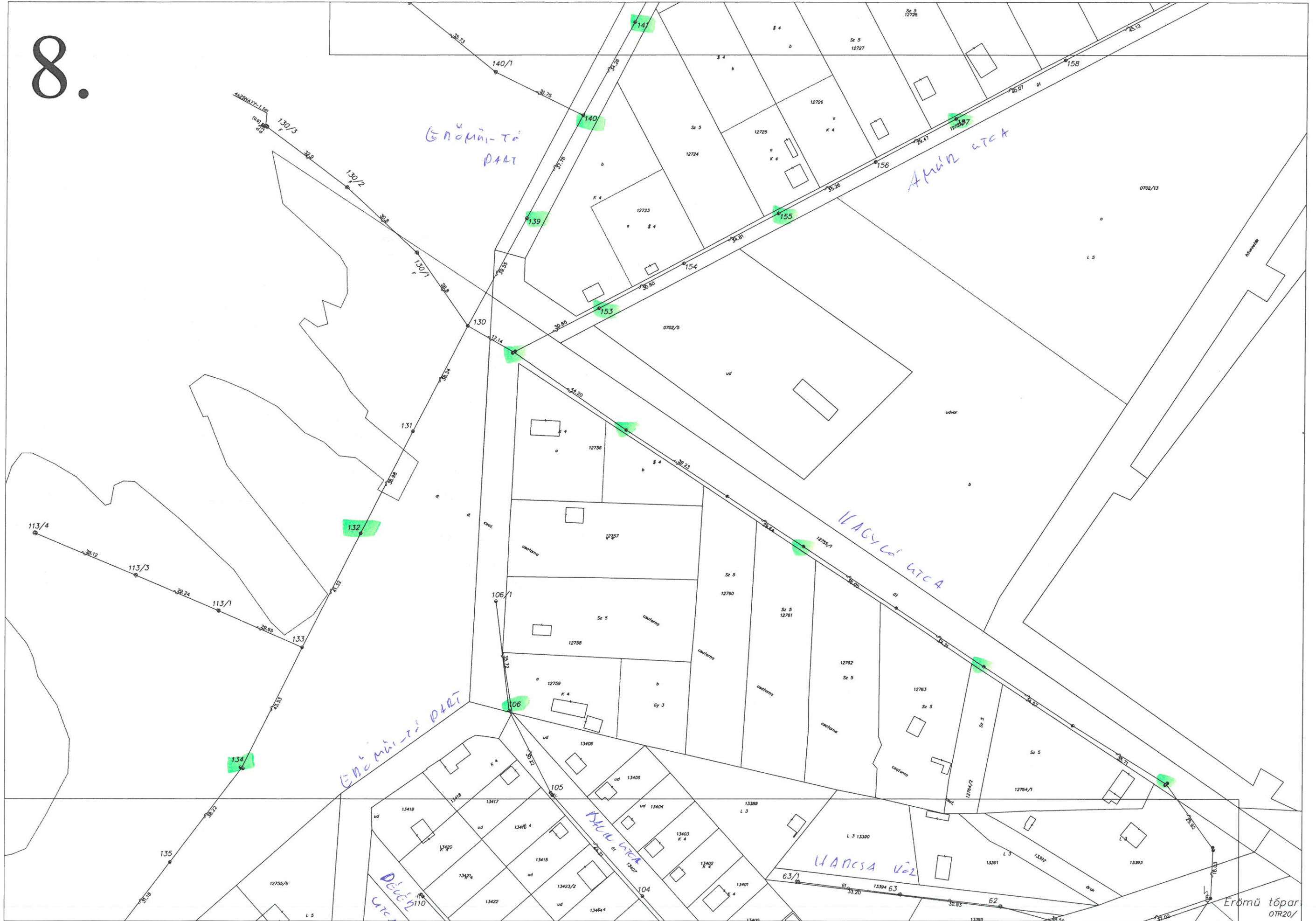

32d



9.

C. DE MHI-TE PART

HANDS 4 UTEA

C. DE MHI-TE PART

SAGEV UTEA

KANDSA UTEA

CSUKA UTEA

HANDS 4 UTEA

CSUKA UTEA

PÖNY UTEA

KANDSA UTEA

MAQUAK UTEA

27 dB + 1 di asslar

10.

